

# INSTALLATION GUIDE FOR ROSTA TENSIONERS



## ⚠ WARNING

- Read and follow all instructions carefully
- Disconnect and lock-out power before installation and maintenance
- Avoid contact with rotating parts
- Do not operate equipment without guards in place. Exposed equipment can result in severe injury or death

## ⚠ CAUTION

- Periodic inspections should be performed
- Missing proper maintenance can result in premature product failure and personal injury
- All work should be performed by qualified personnel and compliant with local and national safety regulations

### 1. Accessories installation

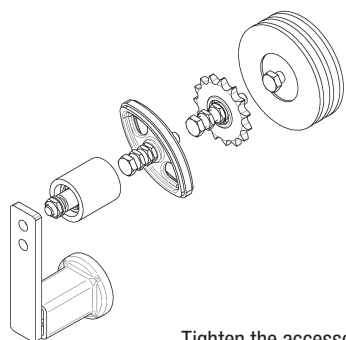

Tighten the accessory slightly

### 2. Tensioner mounting

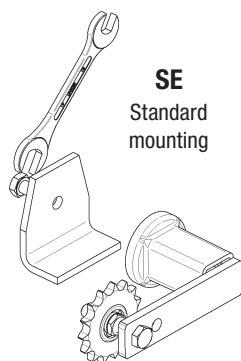

**SE**  
Standard  
mounting

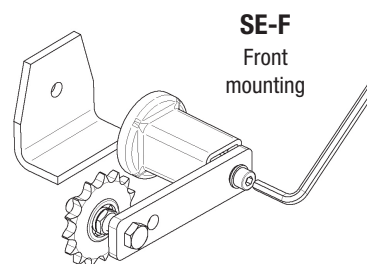

**SE-F**  
Front  
mounting

Tighten the central screw slightly

### 3. Accessories alignment

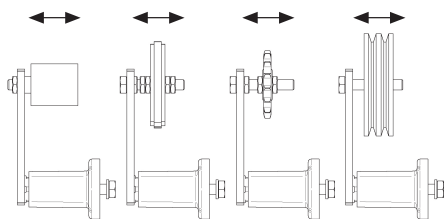

Align and tighten the accessory

### 4. Tensioning

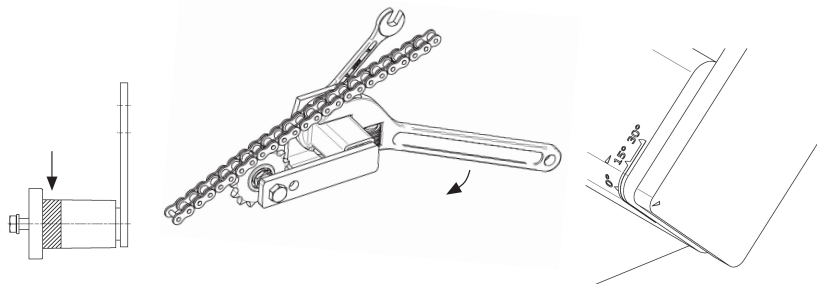

Position the wrench close to the flange-bottom and rotate the housing

Use tensioning angle up to max. 30°  
Typically 15°–25°

### 5. Tightening

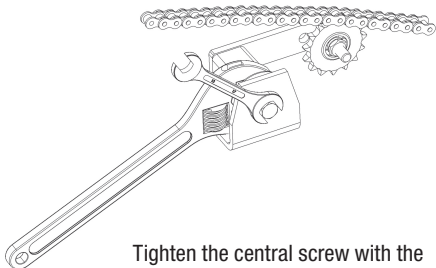

Tighten the central screw with the standard tightening moment

Max. permissible bolt tightening moment			
Type	Screw	Grade	Torque
SE 11	M 6	8.8	10 Nm / 7.4 lb ft
SE 15	M 8	8.8	25 Nm / 18.4 lb ft
SE-F 15	M 6	12.9	17 Nm / 12.5 lb ft
SE 18	M 10	8.8	49 Nm / 36.1 lb ft
SE-F 18	M 8	12.9	41 Nm / 30.2 lb ft
SE 27	M 12	8.8	86 Nm / 63.4 lb ft
SE-F / SE-FE 27	M 10	12.9	83 Nm / 61.2 lb ft
SE 38	M 16	8.8	210 Nm / 154.9 lb ft
SE-F / SE-FE 38	M 12	12.9	145 Nm / 106.9 lb ft
SE 45	M 20	8.8	410 Nm / 302.4 lb ft
SE-F 45	M 16	12.9	355 Nm / 261.8 lb ft
SE 50	M 24	8.8	750 Nm / 553.2 lb ft
SE-F 50	M 20	12.9	690 Nm / 508.9 lb ft

### Positioning notch

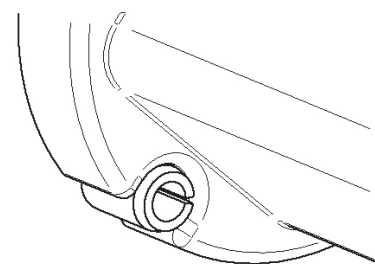

Use e.g. roller pin if necessary